

Horn Antenna 4.9-7.1 GHz

ELL-A3D-SP-04900710



Description

This Horn antenna operates for a frequency from 4.9 GHz to 7.1 GHz.

This antenna is lighter than traditional horn antenna thanks to its innovating additive manufacturing process.

A wide range of gain is available.

The antenna is fed by a SMA-F connector



Technical specifications

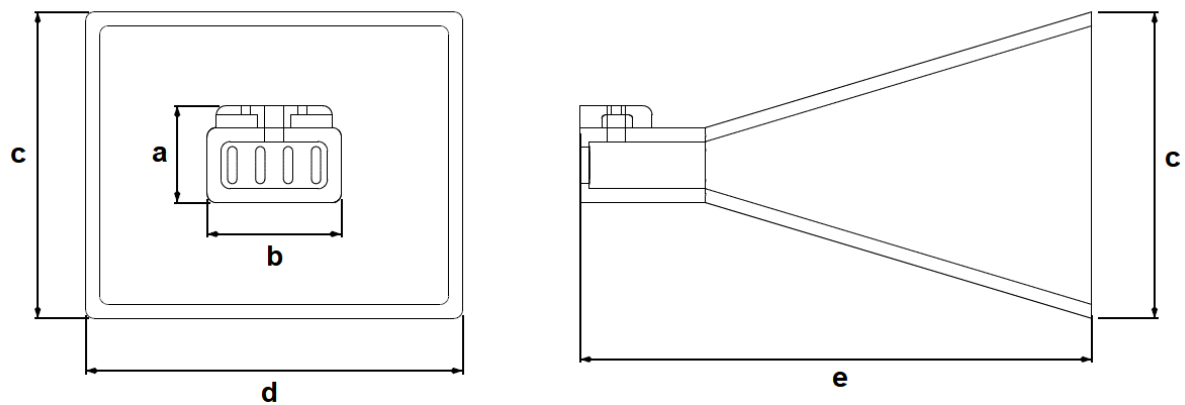

Reference	a (mm)	b (mm)	c (mm)	d (mm)	e (mm)	weight (g)
ELL-A3D-SP-04900710-01	30.90	43.40	66	86	123	~115
ELL-A3D-SP-04900710-02			106	131	190	~230
ELL-A3D-SP-04900710-03			156	206	400	~700

Horn Antenna 4.9-7.1 GHz

ELL-A3D-SP-04900710



Simulation results

1. S11

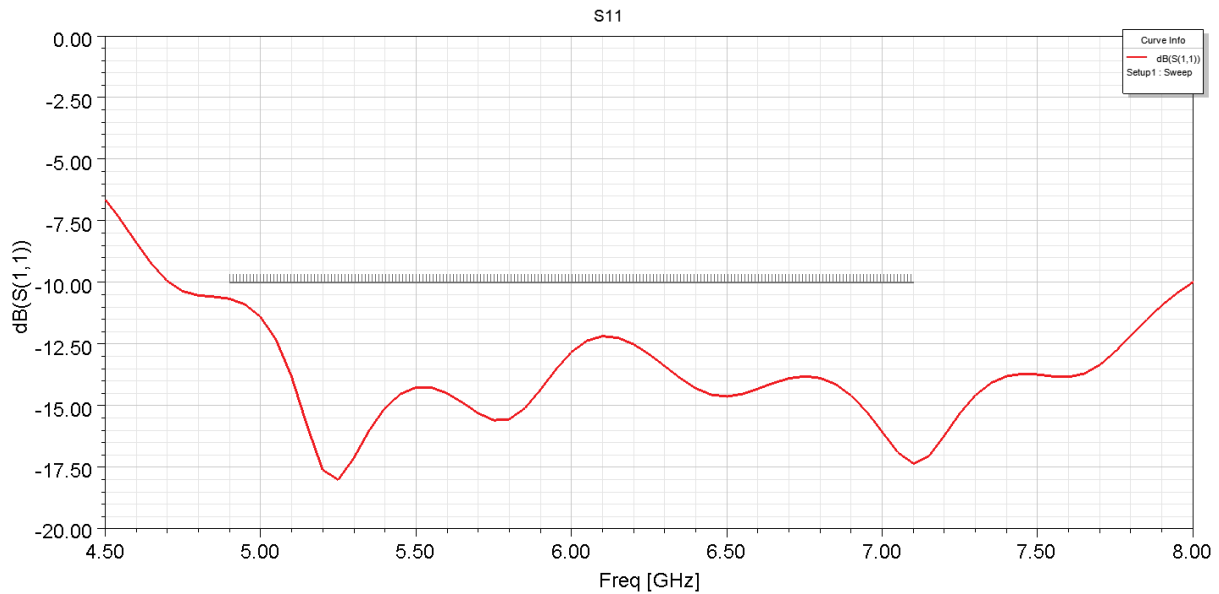

2. Gain

Reference	Gain @8.2 GHz	Gain @12.4 GHz
ELL-A3D-SP-04900710-01	11.5 dBi	14.5 dBi
ELL-A3D-SP-04900710-02	15.5 dBi	18 dBi
ELL-A3D-SP-04900710-03	19 dBi	22 dBi
ELL-A3D-SP-04900710-04	12.5 dBi	15.5 dBi

Horn Antenna 4.9-7.1 GHz

ELL-A3D-SP-04900710



i. ELL-A3D-SP-04900710-01

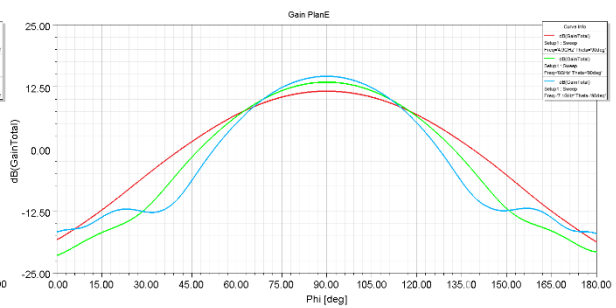
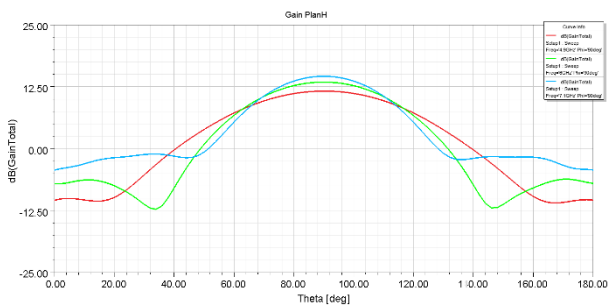
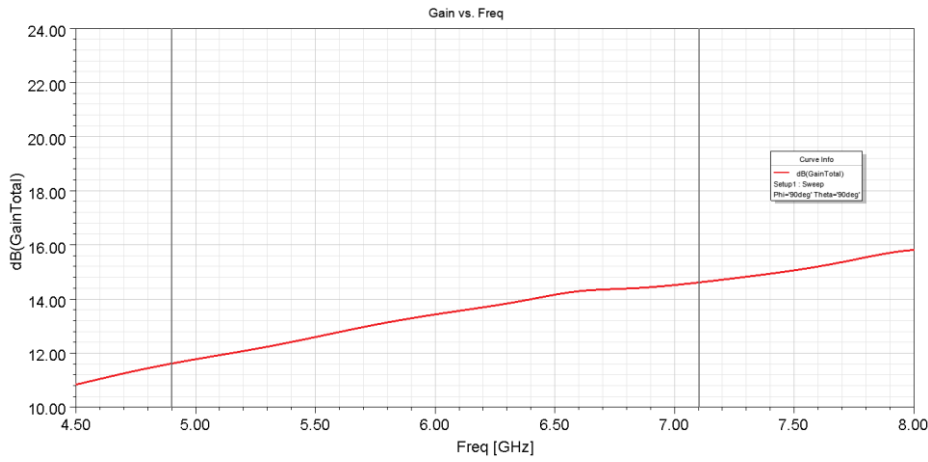

ii. ELL-A3D-SP-04900710-02

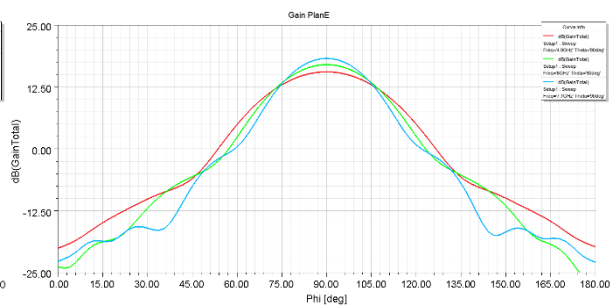
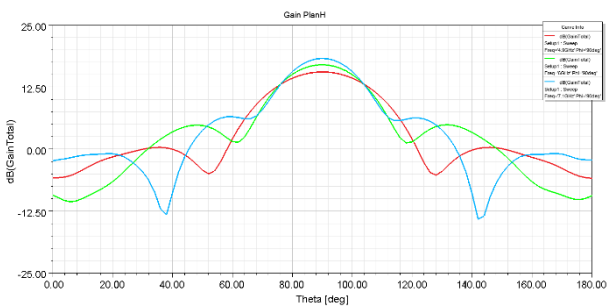
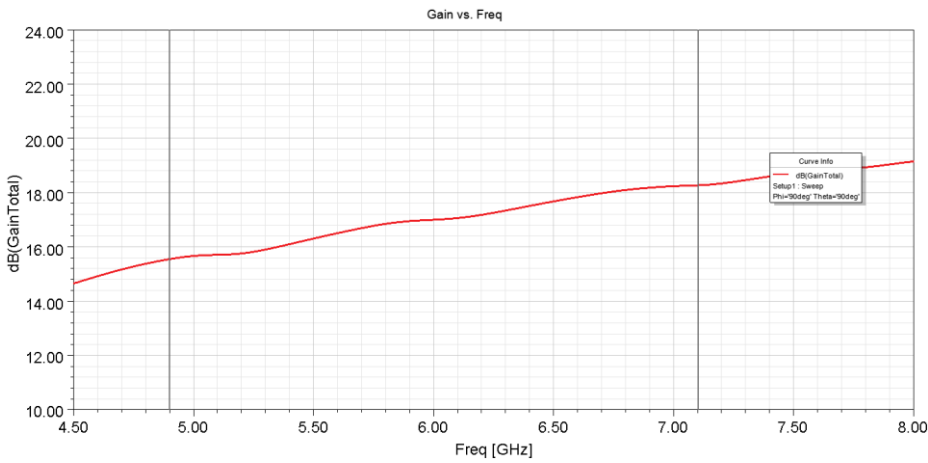

Horn Antenna 4.9-7.1 GHz

ELL-A3D-SP-04900710



iii. ELL-A3D-SP-04900710-03

