

# Horn Antenna 8.2-12.4 GHz

ELL-A3D-SP-08201240



## Description

This Horn antenna operates for a frequency from 8.2 GHz to 12.4 GHz.

This antenna is lighter than traditional horn antenna thanks to its innovating additive manufacturing process.

A wide range of gain is available.

The antenna is fed by a SMA-F connector



## Technical specifications

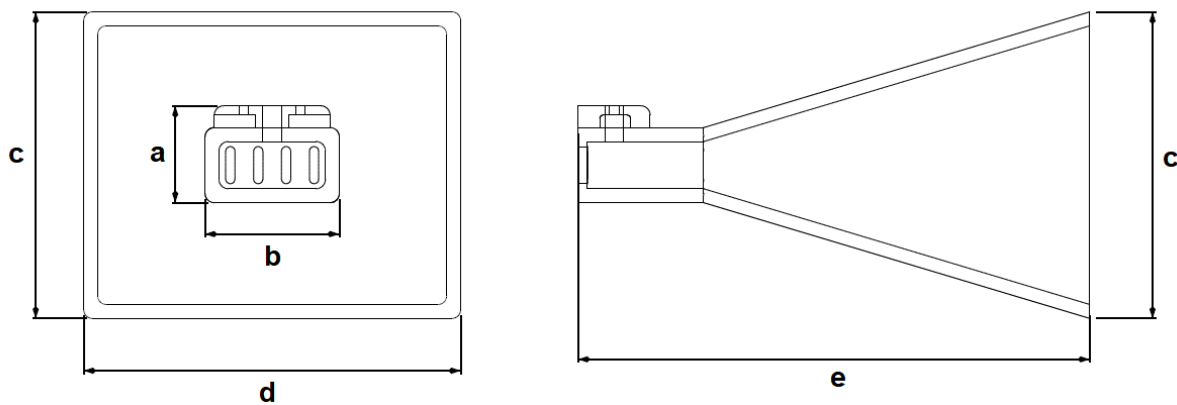

Reference	a (mm)	b (mm)	c (mm)	d (mm)	e (mm)	weight (g)
ELL-A3D-SP-08201240-01	20.86	28.86	39	49	75	~30
ELL-A3D-SP-08201240-02			66	81	110	~80
ELL-A3D-SP-08201240-03			91	126	265	~280
ELL-A3D-SP-08201240-04			46	56	80	~45

# Horn Antenna 8.2-12.4 GHz

ELL-A3D-SP-08201240



## Simulation results

### 1. S11

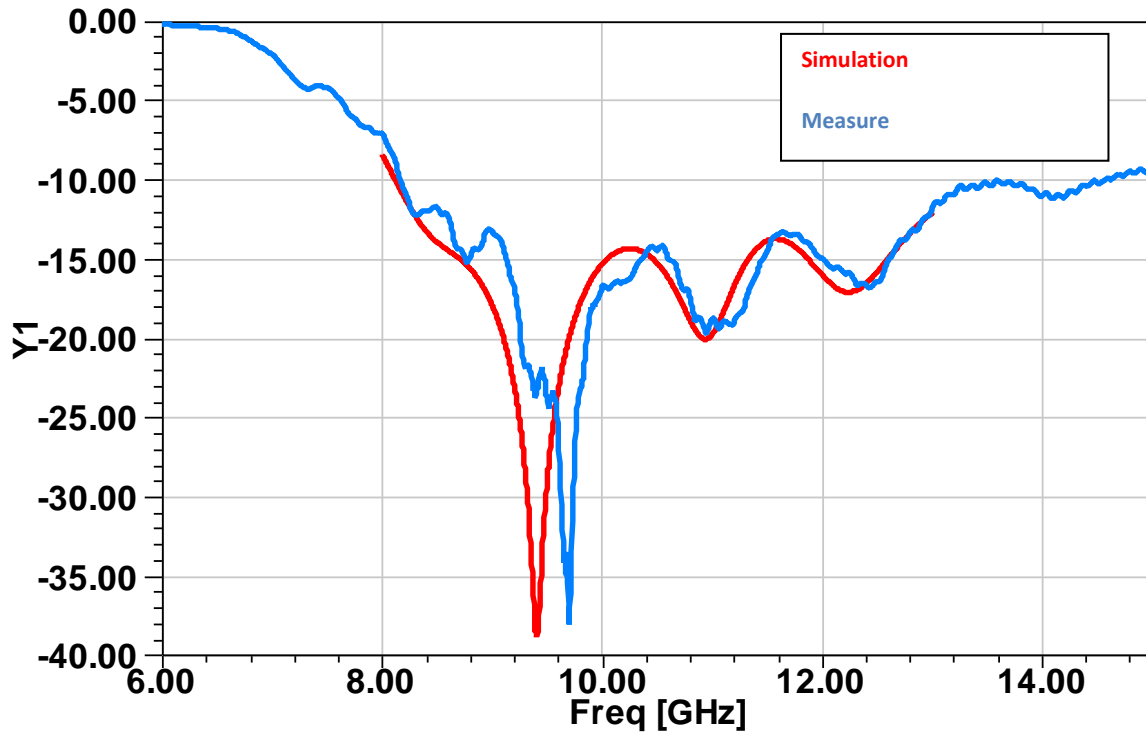

### 2. Gain

Reference	Gain @8.2 GHz	Gain @12.4 GHz
ELL-A3D-SP-08201240-01	11.5 dBi	14.5 dBi
ELL-A3D-SP-08201240-02	15.5 dBi	18 dBi
ELL-A3D-SP-08201240-03	19 dBi	22 dBi
ELL-A3D-SP-08201240-04	12.5 dBi	15.5 dBi

#### i. ELL-A3D-SP-08201240-01

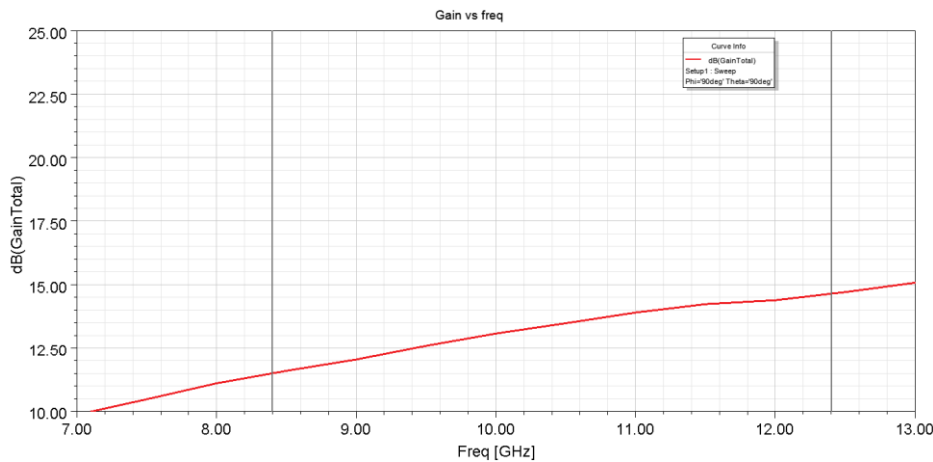

# Horn Antenna 8.2-12.4 GHz

ELL-A3D-SP-08201240

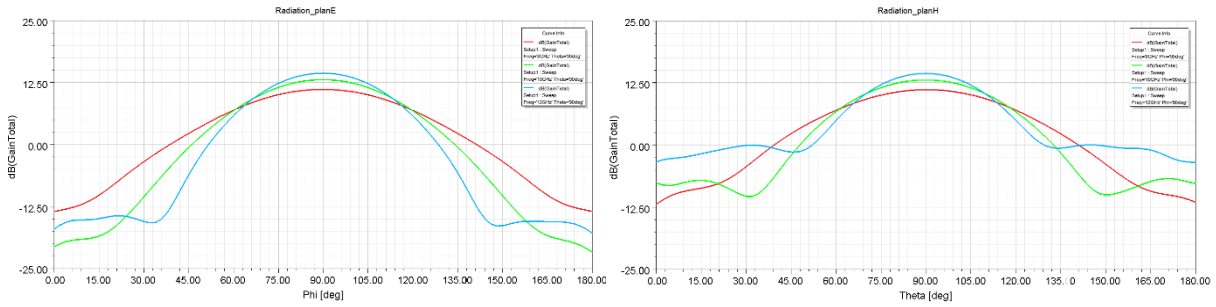

## ii. ELL-A3D-SP-08201240-02

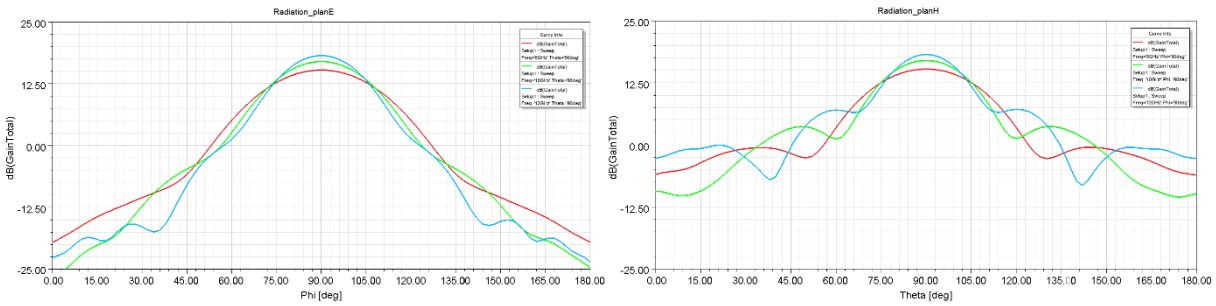
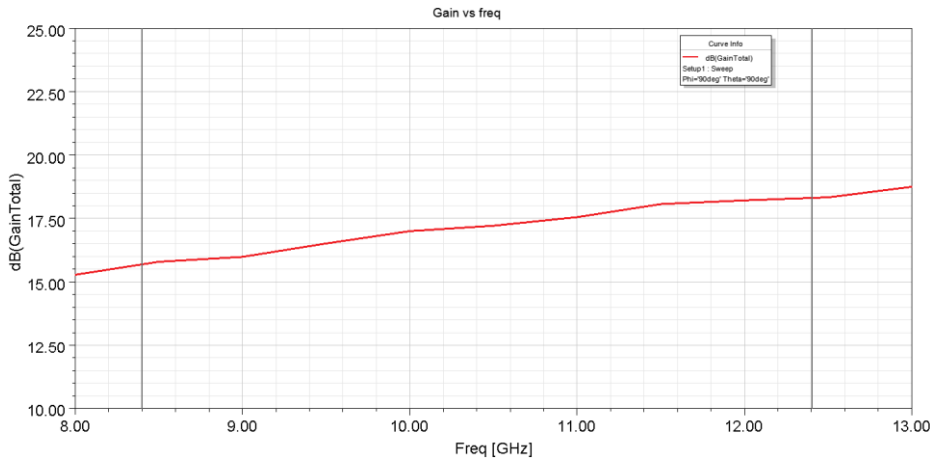

## iii. ELL-A3D-SP-08201240-03

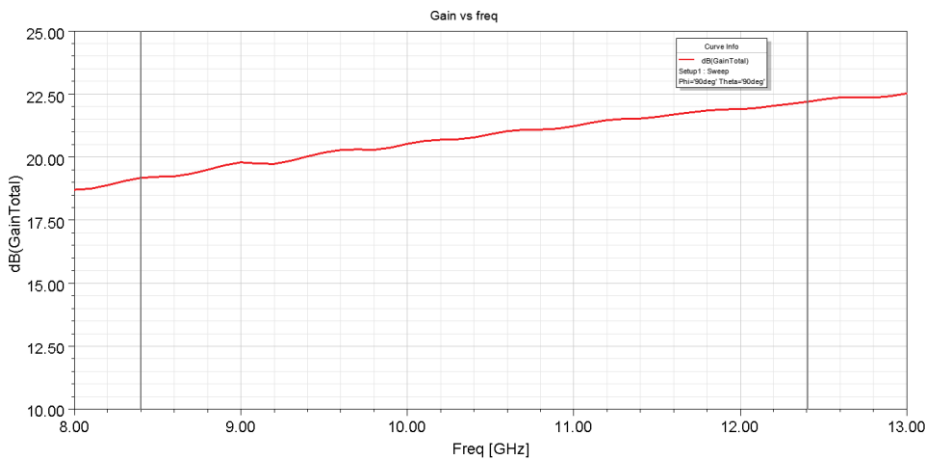

# Horn Antenna 8.2-12.4 GHz

ELL-A3D-SP-08201240

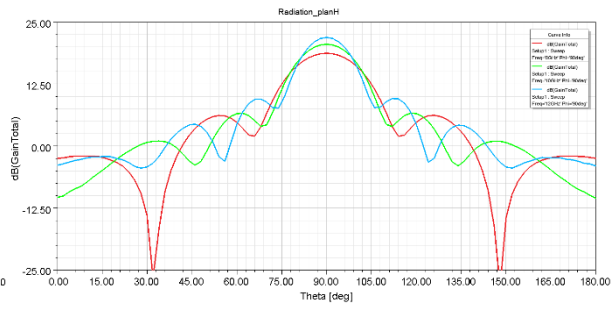
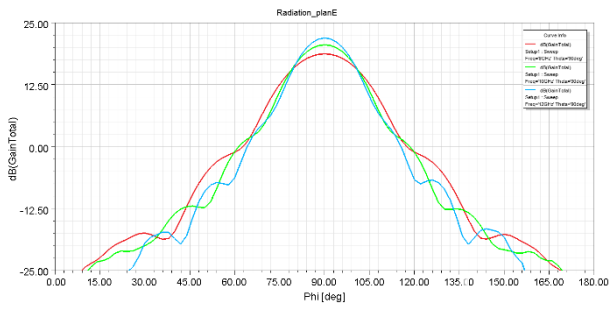

## iv. ELL-A3D-SP-08201240-04

